

5	4	3	2	1
PART NUMBER	ITEM ① BODY	ITEM ② INSULATOR	ITEM ③ CONTACT	ITEM ④ NUT
25-7500	BRASS NICKEL PLATED	TEFLON	BERLLIUM NICKEL PLATED	ZINC NICKEL PLATED

DRAWING NO. 25-7500	
<b>REVISIONS</b>	
A	RELEASE FOR QUOTATION 02-24-06 Y U W T
B	ADD NOTES 4 & 5 10-31-06 Y U W T
C	DEL. DIM. $\phi 13.8$ & $\phi 1.32$ 11-29-06 Z Y T

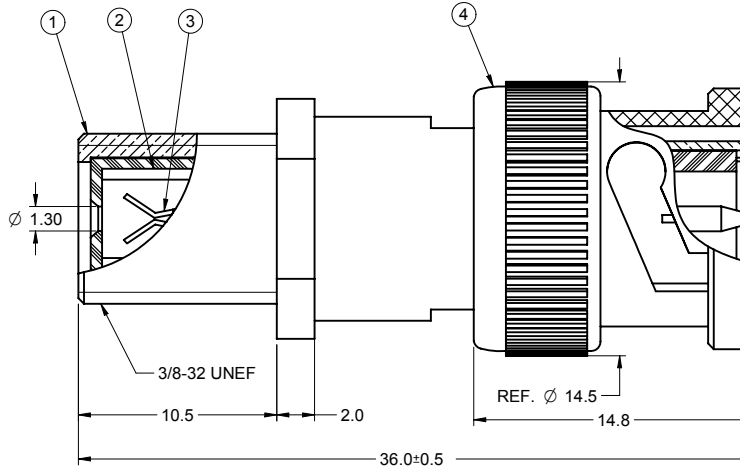
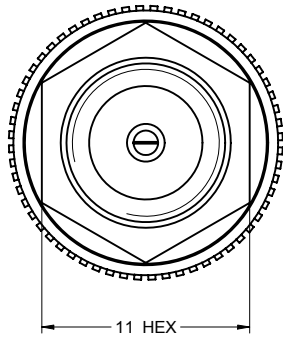

**NOTES:**

- ELECTRICAL SPECIFICATIONS**  
 IMPEDANCE: 50 OHMS NOMINAL  
 FREQUENCY RANGE: 0-4 GHz  
 WORKING VOLTAGE: 500 Vrms MAX AT SEA LEVEL  
 DIELECTRIC WITHSTANDING VOLTAGE: 1500 vrms AT SEA LEVEL  
 CORONA LEVEL: 375 VOLTS MINIMUM AT 70,000 FEET  
 CONTACT RESISTANCE: OUTER-0.2 MILLIOHMS MAXIMUM  
 CENTER-2.1 MILLIOHMS MAXIMUM  
 INSULATION RESISTANCE: 5000 MEGOHMS MINIMUM
- MECHANICAL SPECIFICATIONS**  
 DURABILITY: 500 CYCLES MIN
- ENVIRONMENTAL SPECIFICATIONS**  
 RECOMMENDED TEMPERATURE RANGE: -55 °C TO +85°C  
 MOISTURE RESISTANCE: MIL-STD-202
- PRODUCT SHOULD BE RoHS COMPLIANCE**
- PACKAGING REQUIREMENT FOLLOWS ENGINEERING DOCUMENT P/N 836-40200001XX.**



THIS DRAWING TO BE INTERPRETED  
PER ANSI Y 14.5M - 1994

**COMPANY CONFIDENTIAL**

TOLERANCE UNLESS OTHERWISE SPECIFIED		DRAWN BY GARY.ZHG	DATE 11-29-06	<b>EMERSON</b> Network Power <b>Connectivity Solutions</b>
DECIMALS	mm	CHECKED BY BETTY.YU	DATE 11-29-06	
X	± 0.3	APPROVED BY THOMAS	DATE 11-29-06	
X.X	± 0.2			
X.XX	± 0.1			
ANGLES	± 0.5°	U/M	mm	
THIS DRAWING WAS PRODUCED BY COMPUTER. DO NOT SCALE DRAWING OR UPDATE MANUALLY.				TITLE F FEMALE TO BNC MALE ADAPTOR
SHEET 1 OF 1	DRAWING NO. 25-7500	SIZE C		